



REEDS LAKE TRAIL BLAZER

VOLUNTEER GUIDE

CONTENTS

Letter from the Board of Directors	3
Pre-Registered Check In & Registration Table	4
Road Closure Management	5
Course Map	8
Road Closure Map	9
Volunteer Parking	10



TO OUR VOLUNTEERS,

Thank you for volunteering and helping us make this year's Reeds Lake Trail Blazer another success, as it is truly appreciated.

The Reeds Lake Trail Blazer Run has a rich history in our community, bringing together participants of all ages and abilities to enjoy the scenic beauty of Reeds Lake while promoting health, wellness and camaraderie.

Over the years, this event has grown not only as a beloved holiday tradition, but also as a cornerstone for community engagement and local pride. Your support as volunteers is what makes it possible to maintain a welcoming and spirited atmosphere that kicks off our community's Fourth of July festivities.

By giving your time and energy, you are also supporting the East Grand Rapids Community Foundation's mission to enhance the quality of life for everyone in our City.

Proceeds from the Trail Blazer help fund community improvements. Your involvement also ensures that these important improvements continue, making a lasting impact on current and future generations in East Grand Rapids.

The following guide is to help make your volunteer experience safe and stress free.

Sincerely,
EGRCF Board of Directors
City of EGR Staff



PRE-REGISTERED CHECK IN & REGISTRATION TABLE

Each volunteer is asked to smile and thank each registrant.

Pre-Registered Check In

5-7 p.m. July 2

Volunteer will check-in registrant, provide number to other volunteer(s). Please be sure to smile, thank the registrant and guide them to the next stop for their number and event shirt. Also direct individuals to the registration desk if they are not on the list.

Shirt and Number

6:30-8:30 a.m. July 4

Volunteer will gather the event shirt according to the assigned size and the registrant's number as it is assigned. They will also direct registrants to the starting area and water a fruit table. A laminated map will be available for the volunteer to point to.

Registration Table (for day-of and last-minute registrants)

6:30-8:30 a.m. July 4

Volunteer will have access to software to easily process the new registrant. They will coordinate with another volunteer to provide registrants with a number and event shirt.



ROAD CLOSURE MANAGEMENT

All volunteers assigned to a traffic post must wear a traffic safety vest.

Traffic post volunteers will need to be available from 8:15-9:30 a.m. race day.

Please review the following maps to find your assigned area – we are unable to provide transportation to each post. The race route is shown by a **dark blue line** showing the start of the race with an **orange line** showing the return.



WEALTHY STREET & LAKESIDE DRIVE SE

There will be cones and a "Road Closed" sign. Volunteer will stand in proximity of the **X**.

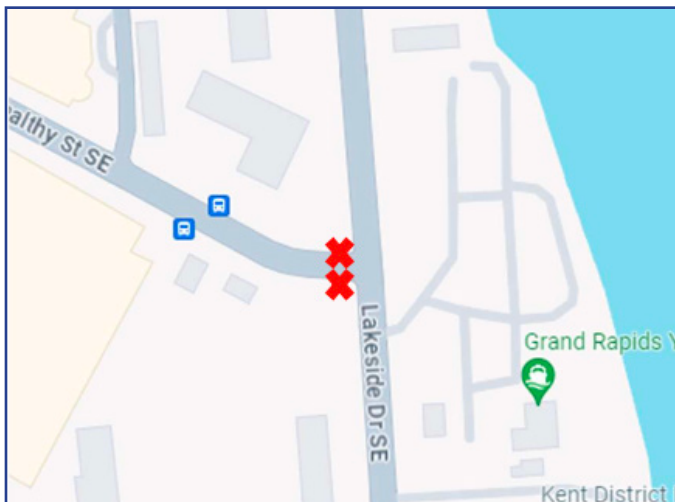

LAKESIDE DRIVE SE & REEDS LAKE BOULEVARD

There will be Public Safety presence, cones and a "Road Closed" sign. Volunteer will stand in proximity of the **X**.



GREENWOOD AVENUE SE & LAKESIDE DRIVE SE

Volunteers will stand at the **X** and redirect traffic to the shopping center, Greenwood Avenue SE to the east, or Lakeside Drive SE to the north.

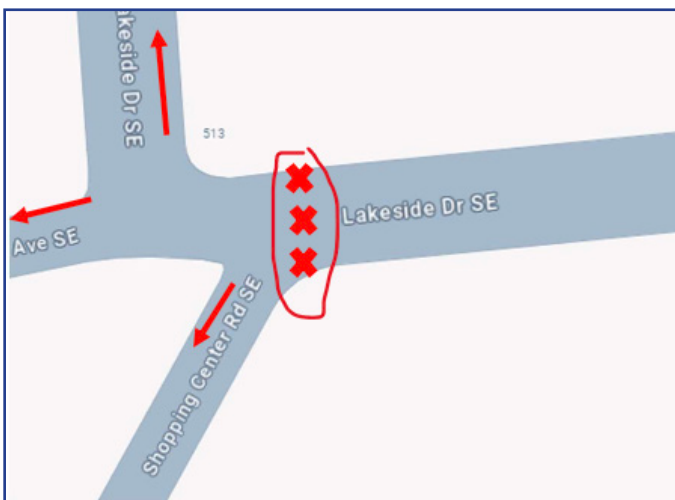

REEDS LAKE ARM N AND REEDS LAKE BLVD SE

Volunteers will stand at the **X** and redirect traffic back onto Robinson Road.

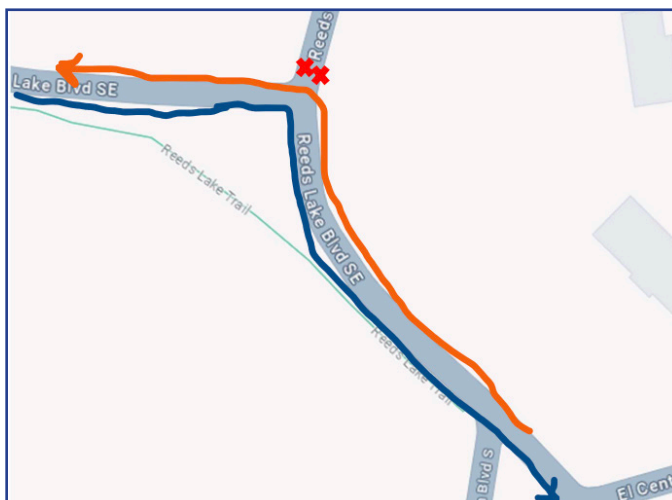

REEDS LAKE ARM NORTH & REEDS LAKE BOULEVARD SE

Volunteers will stand at the **X** and be willing to redirect traffic back onto Hodenpyl Road SE north.

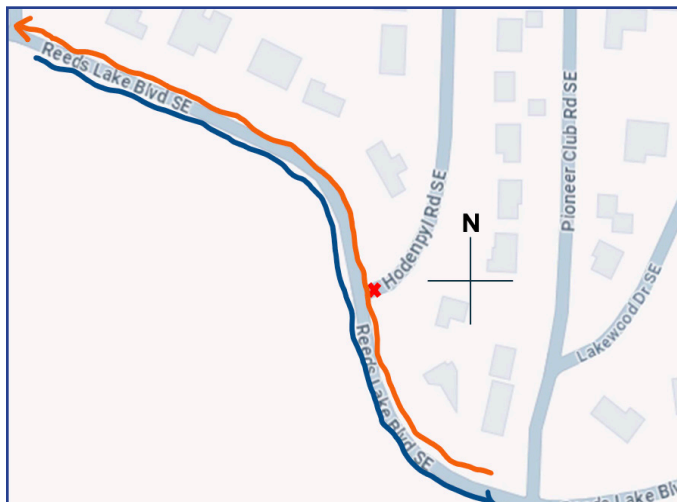

LAKESIDE DRIVE SE & REEDS LAKE BOULEVARD

Volunteers will stand at the **X** at three different locations and redirect traffic:

1. Back north on Pioneer Club Road SE at the intersection of Reeds Lake Boulevard and Pioneer Club Road SE.
2. On Reeds Lake Boulevard SE back east on Reeds Lake Boulevard SE.
3. Back east on Pioneer Club Road SE toward Manhattan Road SE from the turning point of the race on Pioneer Club Road SE and the trail.

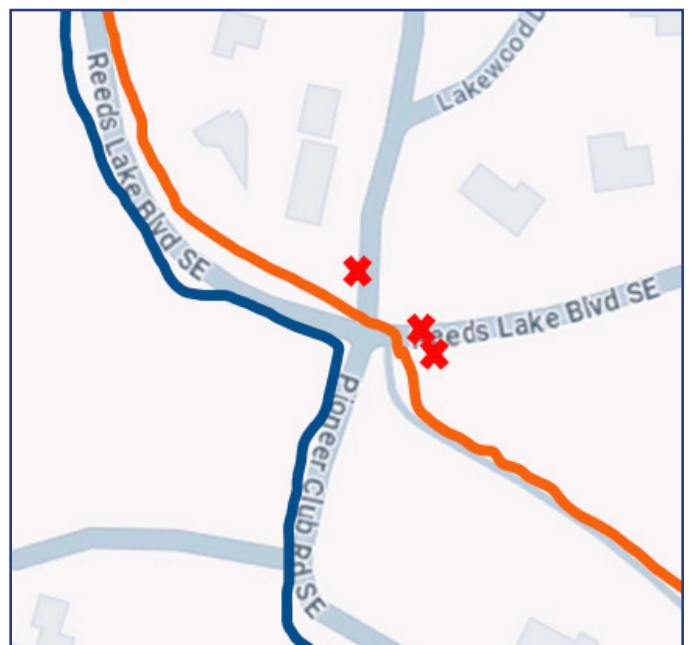

TURNAROUND POINT AT PIONEER CLUB ROAD SE

Volunteers will stand at the **X** and direct participants along the turnaround point on Pioneer Club Road SE.



REEDS LAKE TRAIL BLAZER COURSE



ROAD CLOSURES OVERVIEW

The maps below show all areas of access that will be closed during the event. Please walk to the Community Center, 750 Lakeside Drive SE, from your parking area for volunteer check in.



VOLUNTEER PARKING

All volunteers should park in lots shown below.

